



CR0058

**FITTING INSTRUCTIONS FOR CR0058BK/WH OFFSET COTTON REELS**  
**KAWASAKI Z900 2017-**

Page | 1



**THIS KIT CONTAINS THE ITEMS PICTURED AND LABELLED BELOW.**  
**DO NOT PROCEED UNTIL YOU ARE SURE ALL PARTS ARE PRESENT.**

Please note that the way the kit is packed does not necessarily represent the way of mounting to the bike

THE PARTS SHOWN MAY BE REPRESENTATIVE ONLY (FOR CLARITY OF INSTRUCTIONS ONLY)

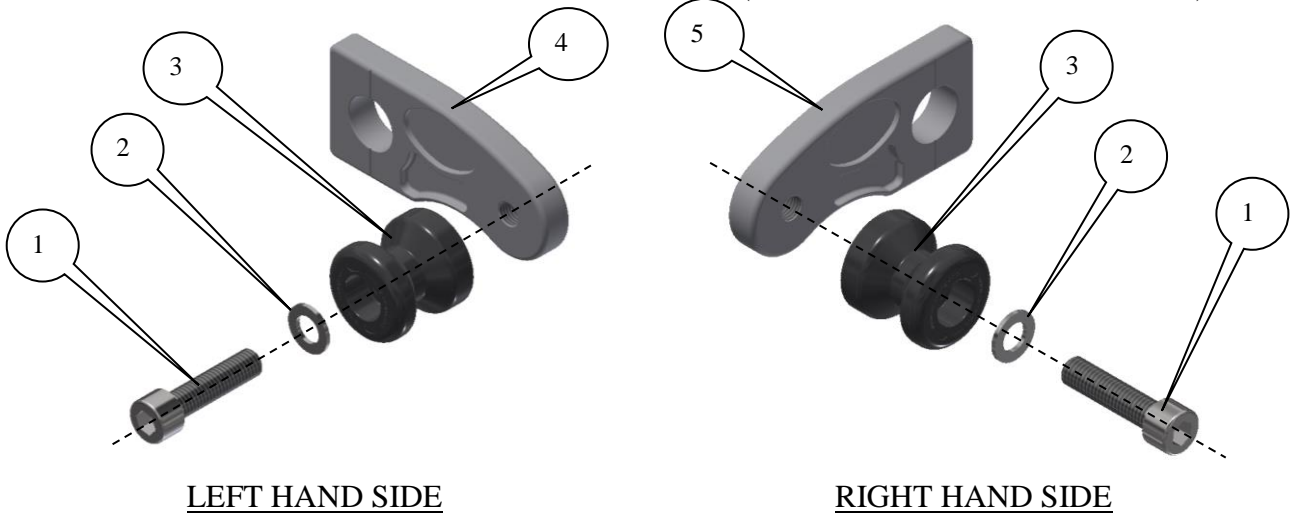

LEFT HAND SIDE

RIGHT HAND SIDE

**LEGEND**

ITEM 1 = M10 x 1.25 x 40mm LONG CAP HEAD BOLTS (x2).

ITEM 2 = M10 WASHERS (x2).

ITEM 3 = COTTON REEL BOBBIN (B0300 with CS303) (x2).

ITEM 4 = LEFT HAND SIDE REPLACEMENT ADJUSTER BLOCK/COTTON REEL MOUNT (x1) (M0233).

ITEM 5 = RIGHT HAND SIDE REPLACEMENT ADJUSTER BLOCK/COTTON REEL MOUNT (x1) (M0500).

R&G Racing

Unit 1, Shelley's Lane, East Worldham, Alton, Hampshire, GU34 3AQ

Tel: +44 (0)1420 89007 Fax: +44 (0)1420 87301 [www.rg-racing.com](http://www.rg-racing.com) Email: [info@rg-racing.com](mailto:info@rg-racing.com)



CR0058

Please note that in cases where kits are packed with rubber washers holding the components onto the bolt – *the rubber washers should be thrown away!*

### **TOOLS REQUIRED**

Page | 2

- Set of Metric Allen keys to include 8mm A/F.
  - 27mm A/F socket & wrench.
  - Pliers.
- Torque wrench to be used at manufactures recommended Torque settings.
  - Paddock stand.

### **FITTING INSTRUCTIONS**

Please read all instructions before commencing fitting

- Raise rear of bike on paddock stand bobbins (not supplied—product code CR0057), support the rear wheel (suggest using blocks of wood) to prevent wheel from dropping when rear spindle is removed.
- Remove the rubber nut cover if fitted from the left-hand side of the rear wheel spindle.
- Remove the split pin.
- Undo and remove the rear spindle nut.
- Remove the rear spindle.
- Remove the OEM chain adjuster blocks.
- Place the new right hand adjuster block/cotton reel mount (item 5-shown above right) onto the rear wheel spindle as original.
- Slide the spindle with the adjuster block/ cotton reel mount through the right-hand side of the swing arm, rear wheel, brake calliper and left hand side of the swing arm.
- Place the remaining adjuster block/cotton reel mount (item 4-shown above left) over the exposed spindle and into adjuster slot on the left-hand side.
- Refit the spindle washer and nut and tighten according to the manufactures instructions and check chain adjustment (the adjuster blocks have lines to aide adjustment).
- Refit the split pin.
- Fit one M10 bolts (item 3) through either washer (item 2) then through the cotton reel bobbin (item 3), before tightening into the threaded hole in the adjuster block/cotton reel mount, as shown above.
- Repeat the above process on the other side of the bike.
- Fit bubble stickers if not already fitted.
- Refit the rubber nut cover if fitted.
- Remove bike from the paddock stand.

**Digital copies of these instructions are available to download from [www.rg-racing.com](http://www.rg-racing.com)**

### **GENERAL TORQUE SETTINGS**

M4 BOLT = 8Nm  
M5 BOLT = 12Nm  
M6 BOLT = 15Nm  
M8 BOLT = 20Nm  
M10 BOLT = 40Nm

ISSUE 1 31/03/2017 (NSY)

R&G Racing

Unit 1, Shelley's Lane, East Worldham, Alton, Hampshire, GU34 3AQ  
Tel: +44 (0)1420 89007 Fax: +44 (0)1420 87301 [www.rg-racing.com](http://www.rg-racing.com) Email: [info@rg-racing.com](mailto:info@rg-racing.com)



CR0058

**CONSUMER NOTICE**

The catalogue description and any exhibition of samples are only broad indications of the Products and R&G may make design changes which do not diminish their performance or visual appeal and supplying them in such state shall conform to the order. The Buyer acknowledges no representation or warranty (other than as to title) has been given or will apply to the Products other than those in R&G's order or confirmation and the Buyer confirms it has chosen the Products as being of merchantable quality and suitable for its particular purposes. Where R&G fits the Products or undertakes other services it shall exercise reasonable skill and care and rectify any fault free of charge unless the workmanship has been disturbed. The Buyer is responsible for ensuring that the warranty on the motorcycle is not affected by the fitting of the Products. On return of any defective Products R&G shall at its option either supply a replacement or refund the purchase money but shall not be liable if the Products have been modified or used or maintained otherwise than in accordance with R&G's or manufacturer's instructions and good engineering practice or if the defect arises from accident or neglect. Other than identified above and subject to R&G not limiting its liability for causing death and personal injury, it shall not be liable for indirect or consequential loss and otherwise its liability shall be limited to the amounts paid by the Buyer for the Products or the fitting or service concerned. These terms do not affect the Buyer's statutory rights.

Page | 3

**R&G RACING RETURNS POLICY (NON-FAULTY GOODS)**

Returns must be pre-authorized (if not pre-authorized the return will be rejected). Goods may only be returned direct to us if they were purchased direct from us (customer must prove if necessary). Otherwise to be returned to original vendor. Goods must be in re-sellable condition, in the opinion of R&G Racing. All returns are subject to a 25% restocking and handling fee (25% of the gross value exc. P&P – at the prevailing price at time of purchase). The customer must pay any and all carriage charges. No returns of discontinued products, unless within 14 days of purchase. This policy does not affect your statutory rights and does not refer to faulty goods.

R&G Racing

Unit 1, Shelley's Lane, East Worldham, Alton, Hampshire, GU34 3AQ

Tel: +44 (0)1420 89007 Fax: +44 (0)1420 87301 [www.rg-racing.com](http://www.rg-racing.com) Email: [info@rg-racing.com](mailto:info@rg-racing.com)



CR0058

**NOTICE DE MONTAGE POUR CR0058BK/WH BOBINES DECALÉES  
KAWASAKI Z900 2017-**

Page | 4

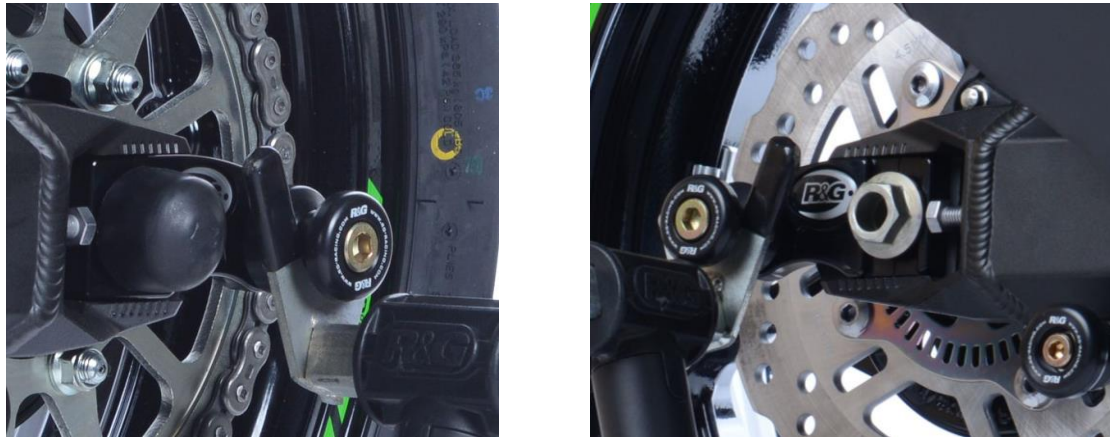

**LE KIT CONTIENT LES ARTICLES EXPOSES CI-DESSOUS, VERIFIER QUE TOUTES LES PIECES  
SOIENT PRESENTES AVANT DE PROCEDER AU MONTAGE.**

**LA FAÇON DONT LE KIT EST EMBALLE NE CORRESPOND PAS FORCEMENT A LA FAÇON DE  
MONTER LES PIECES SUR LA MOTO.**

**LES PARTIES PRESENTEES PEUVENT ETRE UNIQUEMENT  
REPRESENTATIVES (POUR LA CLARTÉ) DES INSTRUCTIONS UNIQUEMENT.**

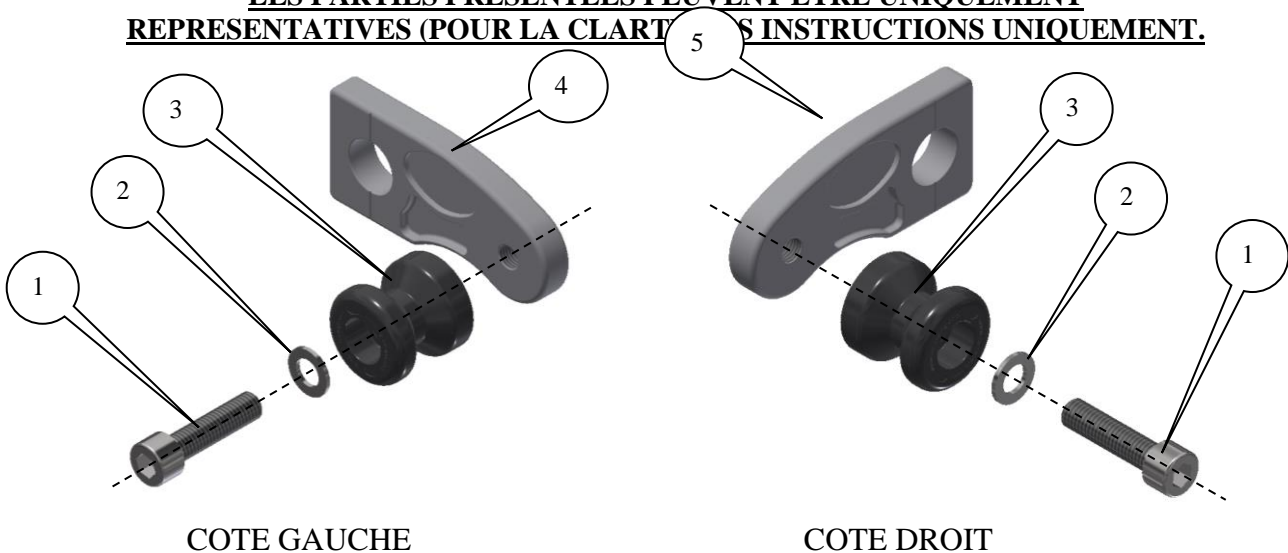

**LEGENDE**

- ARTICLE 1 = M10 x 1.25 x 40mm BOULONS (x2).
- ARTICLE 2 = M10 RONDELLES (x2).
- ARTICLE 3 = BOBINES (B0300 avec CS303) (x2).
- ARTICLE 4 = SUPPORT BOBINE DU BLOC D'AJUSTEMENT DE REMPLACEMENT DU COTE GAUCHE (x1) (M0233).
- ARTICLE 5 = SUPPORT BOBINE DU BLOC D'AJUSTEMENT DE REMPLACEMENT DU COTE DROIT (x1) (M0500).

R&G Racing

Unit 1, Shelley's Lane, East Worldham, Alton, Hampshire, GU34 3AQ

Tel: +44 (0)1420 89007 Fax: +44 (0)1420 87301 [www.rg-racing.com](http://www.rg-racing.com) Email: [info@rg-racing.com](mailto:info@rg-racing.com)



CR0058

Notez que si les kits sont emballés avec des rondelles en caoutchouc servant à tenir les composants, *ces rondelles doivent être jetées !*

Page | 5

### **OUTILS REQUIS**

- Jeu de clés Allen comprenant une clé de 8mm.
  - Clé à cliquet + douille de 27mm.
    - Pincés.
- Clé dynamométrique à utiliser aux couples recommandés.
  - Béquille de stand.

### **NOTICE DE MONTAGE**

#### **Lire la notice avant de procéder au montage**

- Monter l'arrière de la moto sur les bobines de stand (non fournies – code produit CR0057), supporter la roue arrière (nous suggérons d'utiliser des blocs de bois) pour éviter que la roue ne tombe lorsque l'axe sera enlevée.
- Enlever le cache écrou en caoutchouc pour l'installation du coté gauche de l'axe de roue arrière.
- Enlever la broche fendue.
- Défaire puis enlever l'écrou d'axe arrière.
- Enlever l'axe arrière.
- Enlever les blocs d'ajusteur de chaîne d'origine.
- Placer le nouveau support d'ajustement du bloc / de bobine (article 5- indiqué au dessus, à droite) sur l'axe de roue arrière d'origine.
- Glisser l'axe avec le support d'ajustement du bloc / de bobine du coté droit du bras oscillant, de la roue arrière, de l'étrier de frein et du bras oscillant coté gauche.
- Placer le support d'ajustement du bloc/ de bobine (article 4- indiqué au dessus, à gauche) sur l'extrémité de l'axe et dans la fente d'ajustement du coté gauche.
- Remonter la rondelle d'axe et l'écrou puis serrer selon les couples de serrage recommandés puis vérifier la position de la chaîne (les blocs d'ajustement possèdent des lignes pour faciliter l'ajustement).
- Remonter la goupille fendue.
- Insérer un boulon M10 (article 3) dans la rondelle (article 2) puis dans la bobine (article 3), avant de serrer dans le trou fileté du support d'ajustement du bloc/de la bobine, voir ci-dessus.
- Répéter le process ci-dessus de l'autre coté de la moto.
- Insérer des stickers en caoutchouc si cela n'est pas déjà fait.
- Réinsérer le cache écrou en caoutchouc.
- Enlever la moto de sa béquille de stand.

**Notice disponible au téléchargement sur [www.rg-racing.com](http://www.rg-racing.com)**

### **COUPLES DE SERRAGE RECOMMANDES**

M4 BOULON = 8Nm  
M5 BOULON = 12Nm  
M6 BOULON = 15Nm  
M8 BOULON = 20Nm  
M10 BOULON = 40Nm

R&G Racing

Unit 1, Shelley's Lane, East Worldham, Alton, Hampshire, GU34 3AQ  
Tel: +44 (0)1420 89007 Fax: +44 (0)1420 87301 [www.rg-racing.com](http://www.rg-racing.com) Email: [info@rg-racing.com](mailto:info@rg-racing.com)





CR0058

ISSUE 1 31/03/2017 (NSY)

**CONSUMER NOTICE**

The catalogue description and any exhibition of samples are only broad indications of the Products and R&G may make design changes which do not diminish their performance or visual appeal and supplying them in such state shall conform to the order. The Buyer acknowledges no representation or warranty (other than as to title) has been given or will apply to the Products other than those in R&G's order or confirmation and the Buyer confirms it has chosen the Products as being of merchantable quality and suitable for its particular purposes. Where R&G fits the Products or undertakes other services it shall exercise reasonable skill and care and rectify any fault free of charge unless the workmanship has been disturbed. The Buyer is responsible for ensuring that the warranty on the motorcycle is not affected by the fitting of the Products. On return of any defective Products R&G shall at its option either supply a replacement or refund the purchase money but shall not be liable if the Products have been modified or used or maintained otherwise than in accordance with R&G's or manufacturer's instructions and good engineering practice or if the defect arises from accident or neglect. Other than identified above and subject to R&G not limiting its liability for causing death and personal injury, it shall not be liable for indirect or consequential loss and otherwise its liability shall be limited to the amounts paid by the Buyer for the Products or the fitting or service concerned. These terms do not affect the Buyer's statutory rights.

Page | 6

**R&G RACING RETURNS POLICY (NON-FAULTY GOODS)**

Returns must be pre-authorized (if not pre-authorized the return will be rejected). Goods may only be returned direct to us if they were purchased direct from us (customer must prove if necessary). Otherwise to be returned to original vendor. Goods must be in re-sellable condition, in the opinion of R&G Racing. All returns are subject to a 25% restocking and handling fee (25% of the gross value exc. P&P – at the prevailing price at time of purchase). The customer must pay any and all carriage charges. No returns of discontinued products, unless within 14 days of purchase. This policy does not affect your statutory rights and does not refer to faulty goods.

R&G Racing

Unit 1, Shelley's Lane, East Worldham, Alton, Hampshire, GU34 3AQ

Tel: +44 (0)1420 89007 Fax: +44 (0)1420 87301 [www.rg-racing.com](http://www.rg-racing.com) Email: [info@rg-racing.com](mailto:info@rg-racing.com)